

### Specifications

For other materials or modifications, please consult TESCO M.

#### OPERATING PARAMETERS

Pressure rating per criteria of ANSI/ASME B31.3

**Controlled Pressure Range**

5-500 psig / 0.34-34.5 bar

**Design Proof Pressure**

150% of rated pressure

**Design Burst Pressure**

400% of rated pressure

**Leakage**

Bubble-tight

**Flow Capacity**

$C_v = 0.14$

**Operating Temperature**

-15°F to 165°F / -26°C to 74°C

**Maximum Operating Torque**

40 in-lbs / 4.5 N•m

#### MEDIA CONTACT MATERIALS

**Body**

316L Stainless Steel

**Main Valve Seat**

PTFE

**Seal**

PCTFE

**Back-up Rings**

PTFE

**O-Ring**

Nitrile, Buna-N

**Remaining Parts**

300 Series Stainless Steel

#### OTHER

**Weight (approximate)**

**DN 15:** 8 lbs / 3.6 kg

**DN 20/25:** 11 lbs / 5 kg

Teflon® is a registered trademark of E.I. du Pont de Nemours and Company.



TESCOM 26-1700F Series backpressure regulators provide welded flanges according to EN 1092 and are suitable for gas or liquid service.

### Applications

- Pilot plants (i.e. in the chemical industry)
- Pressure control of reactor or vessel applications

### Features and Benefits

- Flange connections according to DIN EN 1092-1 Type 11 for easy line integration
- Face-to-face dimensions according to DIN EN 558, Row 1
- Connection up to DN 25
- Setpoint repeatability exceeds conventional relief valves
- Bubble-tight shutoff at all reseal pressures
- Safe and reliable piston-style sensor
- Compatible with the TESCO M Air Actuator and ER5000 Electropneumatic Controller for remote control
- Other connection standards upon request

**26-1700 SERIES**  
**Europe and Middle East only**  
**26-1700F Series Regulator Drawing**

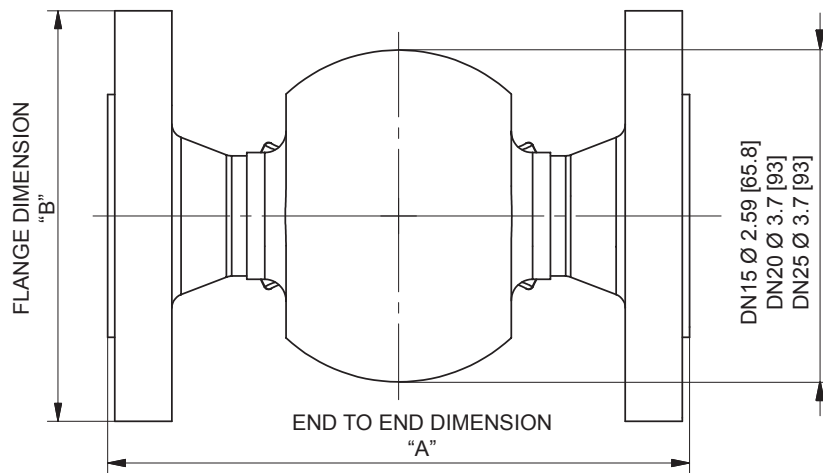
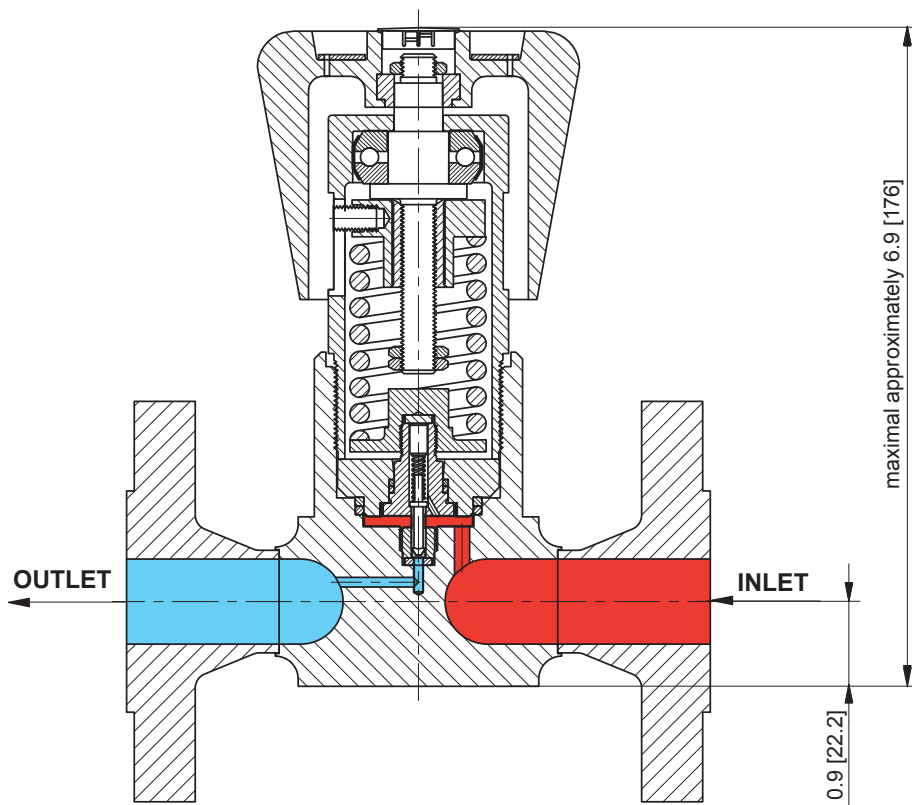

All dimensions are reference & nominal  
 Metric [millimeter] equivalents are in brackets

**26-1700F Series Regulator Flow Chart**

For more information on how to read flow curves, please refer to the Flow Curves and Calculations document (debul2007x012) in the TESCOM catalog or on [www.tescom.com](http://www.tescom.com).

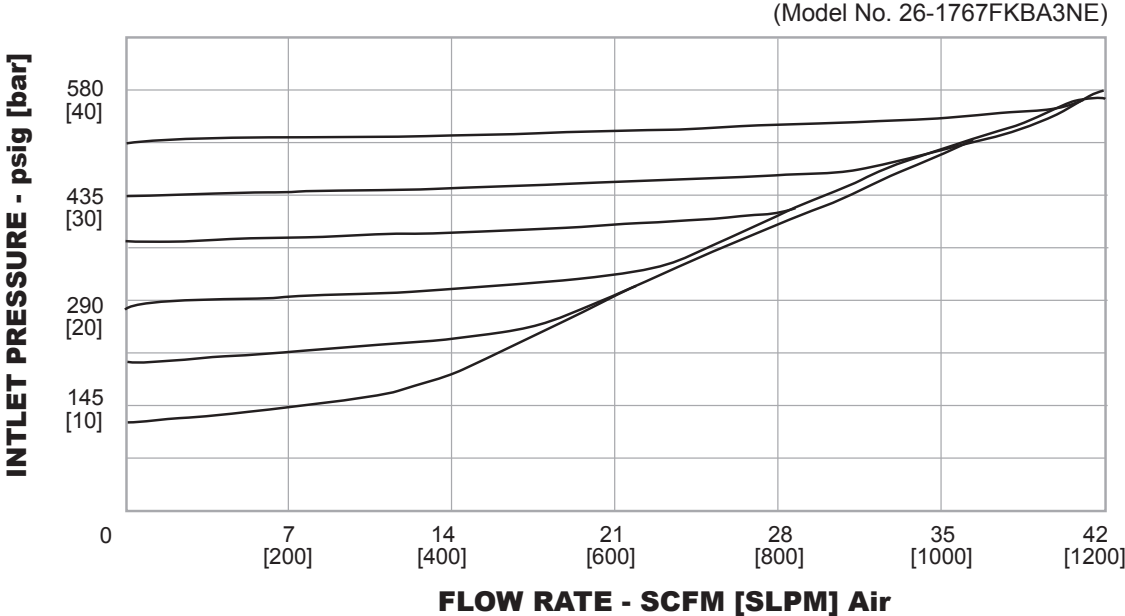

# 26-1700 SERIES

## Europe and Middle East only

### 26-1700F Series Regulator Part Number Selector

Repair Kits, Accessories & Modifications may be available for this product. Please contact TESCOM for more information.

Example for selecting a part number:

BASIC SERIES	BODY AND FLANGE MATERIAL	CONTROLLED PRESSURE RANGE	INLET AND OUTLET PORT TYPE	"A" ±.08" ±2 mm	"B" ±.08" ±2 mm	FLANGE TYPE	GAUGE PORT OPTIONS	FLOW CAPACITY	OPTIONAL ITEM
26-17	6 - 316L Stainless Steel	7 - 5-500 psig 0.34-34.5 bar	K - DN 15 L - DN 20 M - DN 25	5.12 130 6.30 160	3.74 95 4.13 105 4.53 115	B - Form B - raised face D - Form D - ring joint	A - None F - 1/4" NPTF 1 x in G - 1/4" NPTF 1 x in L - 1/4" NPTF 1 x in, 1 x out	3 - $C_v = 0.14$	N - None

## Kits

	BASIC SERIES	PART NUMBER
NON METALLIC	26-17XXFXXXXXX	389-1268
REPAIR	26-17XXFXXXXXX	389-6574